

SWITCH

5-PORT GIGABIT NANO SWITCH

Item No.: GLB236050

The 5-Port Gigabit Nano Switch offers high performance in a very compact design, great for both office and SoHo use.

The unmanaged switch have 5 auto-sensing Gigabit Ethernet ports that automatically optimize the speed for each connected device to provide a true plug & play solution for expanding your office or home network.



FEATURES

- ▶ Supports IEEE802.3x flow control for Full Duplex mode and backpressure for half-duplex mode
- ▶ Transmission Distance up to 100 meters, speed up to 1 Gbps
- ▶ Keyholes for easy screw mounting under desk or on wall
- ▶ Energy saving technology reduces power consumption up to 85%

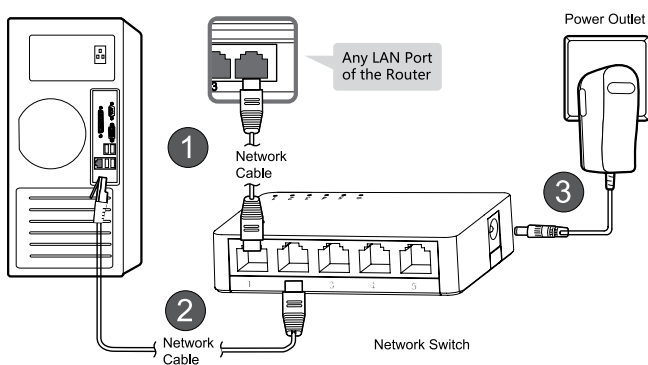

Device Connection Diagram

SPECIFICATIONS

Interface	5 10/100/1000/Mbps RJ45 Ports AUTO Negotiation/AUTO MDI/MDIX
Chip	EN8850
Switching Capacity	10 Gbps
Power Input	External Power adapter 5V DC/1A.
LED	Power, 10/100M,1000M, LINK, ACT
Fan	Fanless
Housing	Plastic Housing
Dimension	82.6*48.6*20.5mm
Advanced Functions	Green Technology, saving power up to 85% 802.3X Flow Control, Back Pressure Auto-Uplink Every Port
Contents	1x 5-Port 10/100/1000Mbps Unmanaged Desktop Switch 1x Power Adapter